

YB08576-1	Door Style: F30-70-70-3"S&R	Finished Left: YES	Cabinet Type: WSP-HOOD
	Door Material: HDF	Finished Right: YES	Dwr Front Type: -
#15	Case Material: 5/8 PB	Finished Top: -	Dwr Box Type: -
	Inside Material: NMM	Finished Bottom: YES	Hinge: TOP
Qty=1	Base Type: -	Finished Interior: -	Edge Profile: -

DRAWING 1 OF 3

- CUSTOM HOOD CABINET

CURVED SECTION AND PANEL ATTACHED w/HINGES AND FALSE FRONT CLIPS

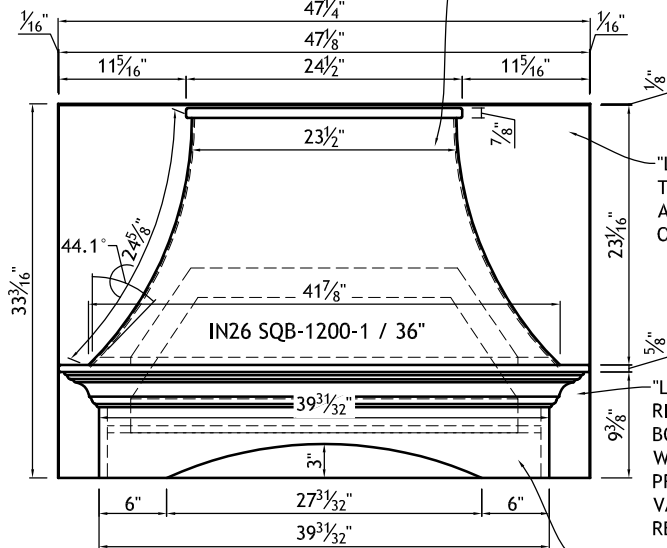

FRONT VIEW

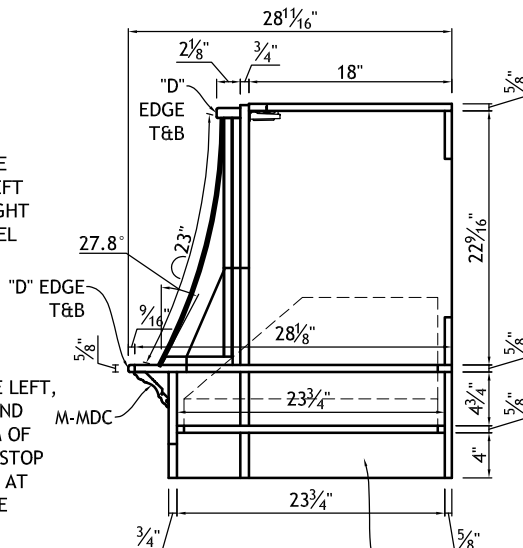

SECTION VIEW

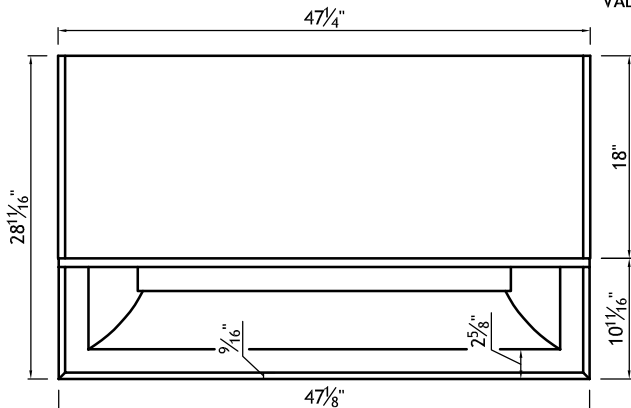

PLAN VIEW

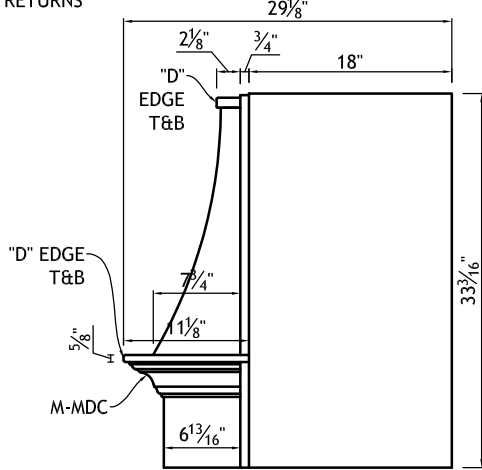

SIDE VIEW

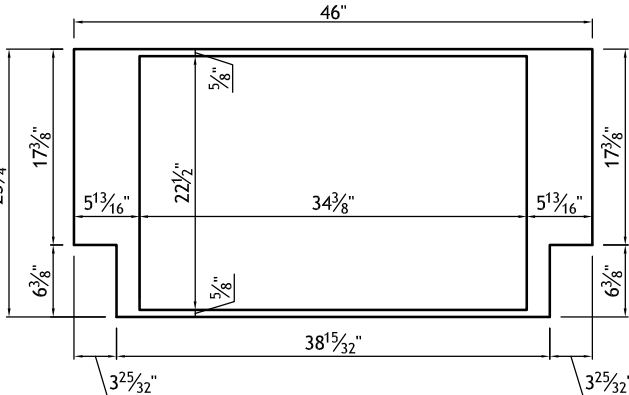

LOWER FLOOR DETAIL

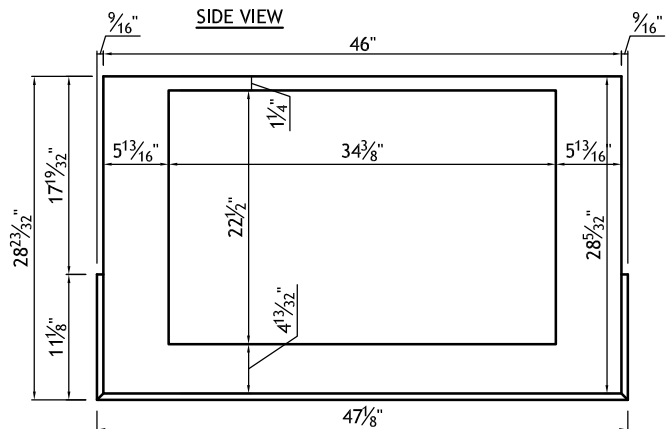

MIDDLE FLOOR DETAIL

Dealer Signoff:

YB08576-1	Door Style: F30-70-70-3"S&R	Finished Left: YES	Cabinet Type: WSP-HOOD
	Door Material: HDF	Finished Right: YES	Dwr Front Type: -
#15	Case Material: 5/8 PB	Finished Top: -	Dwr Box Type: -
	Inside Material: NMM	Finished Bottom: YES	Hinge: TOP
Qty=1	Base Type: -	Finished Interior: -	Edge Profile: -

DRAWING 2 OF 3

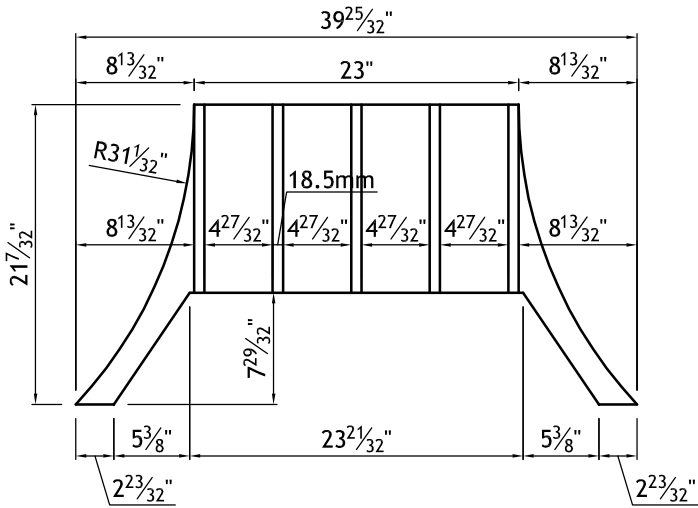

FRONT PANEL

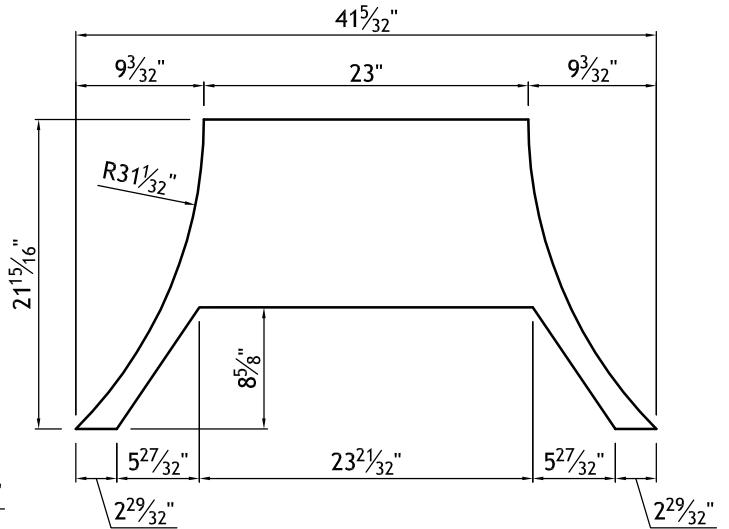

MIDDLE PANEL

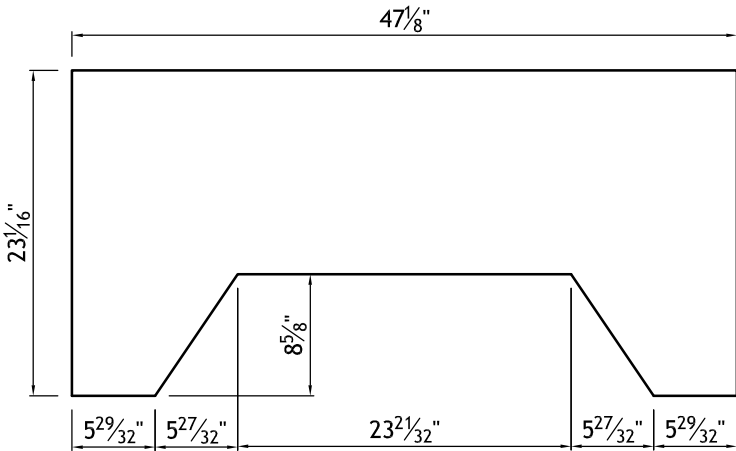

BACK PANEL

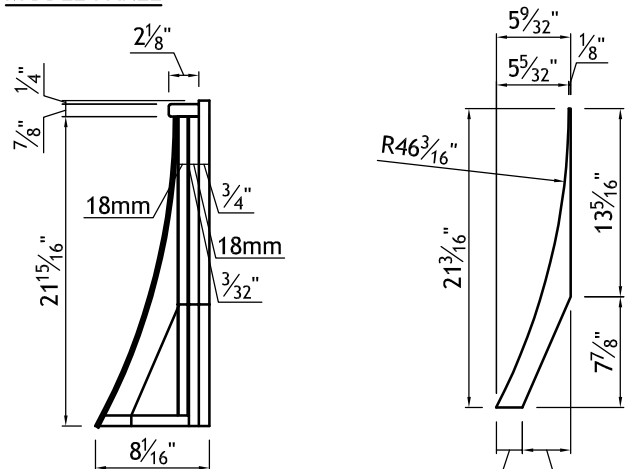

SECTION VIEW OF CURVED REMOVABLE SECTION

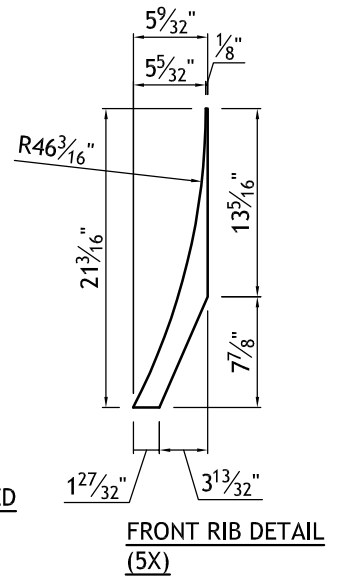

FRONT RIB DETAIL (5X)

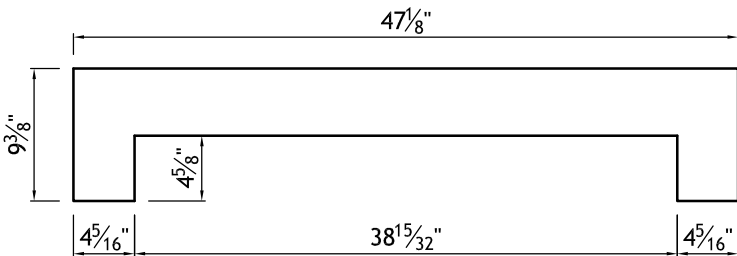

BACK VALANCE DETAIL

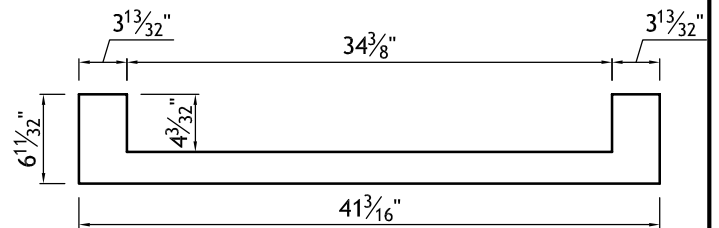

CURVED SECTION FLOOR DETAIL

Dealer Signoff:

YB08576-1	Door Style: F30-70-70-3"S&R	Finished Left: YES	Cabinet Type: WSP-HOOD
#15	Door Material: HDF	Finished Right: YES	Dwr Front Type: -
Qty=1	Case Material: 5/8 PB	Finished Top: -	Dwr Box Type: -
	Inside Material: NMM	Finished Bottom: YES	Hinge: TOP
	Base Type: -	Finished Interior: -	Edge Profile: -

DRAWING 3 OF 3

PARTS LIST:

- 1 TOP FLOOR: 18" x 46" x $\frac{5}{8}$ " NMM/NMM
- 2 SIDES: 18" x $33\frac{3}{16}$ " x $\frac{5}{8}$ " MDF/MDF
- 1 MIDDLE FLOOR: $28\frac{5}{32}$ " x 46" x $\frac{5}{8}$ " MDF/MDF
- 1 LOWER FLOOR: $23\frac{3}{4}$ " x 46" x $\frac{5}{8}$ " MDF/MDF
- 2 HANGER RAILS: $3\frac{15}{16}$ " x 46" x $\frac{5}{8}$ " RAW/RAW
- 1 BACK: $9\frac{3}{8}$ " x 46" x $\frac{5}{8}$ " NMM/MDF
- 1 FRONT VALANCE/RETURNS: $9\frac{3}{8}$ " x $54\frac{19}{32}$ " x $\frac{3}{4}$ " MDF/MDF
- 1 BACK VALANCE: $9\frac{3}{8}$ " x $47\frac{1}{8}$ " x $\frac{3}{4}$ " MDF/MDF
- 1 M-MDC MOULDING: 70" LONG
- 1 MIDDLE FLOOR TRIM: $\frac{5}{8}$ " x $73\frac{3}{8}$ " x $\frac{9}{16}$ " MAPLE
- 1 REMOVABLE SECTION BACK PANEL: $47\frac{1}{8}$ " x $23\frac{1}{16}$ " x $\frac{3}{4}$ " MDF
- 1 CURVED SECTION MIDDLE PANEL: $41\frac{5}{32}$ " x $21\frac{15}{16}$ " x 18mm PLYWOOD
- 1 CURVED SECTION FRONT PANEL: $39\frac{25}{32}$ " x $21\frac{7}{32}$ " x 18mm PLYWOOD
- 1 CURVED SECTION BOTTOM FLOOR: $6\frac{11}{32}$ " x $41\frac{3}{16}$ " x 18mm PLYWOOD
- 1 CURVED SECTION TOP MOULDING: $2\frac{1}{8}$ " x $24\frac{1}{2}$ " x $\frac{7}{8}$ " SOLID MAPLE
- 5 CURVED SECTION FRONT RIBS: $5\frac{9}{32}$ " x $21\frac{3}{16}$ " x 18mm PLYWOOD
- $\frac{1}{8}$ " MDF(2X): 24" x $42\frac{7}{8}$ "
- $\frac{1}{8}$ " MDF(4X): $25\frac{5}{8}$ " X $8\frac{3}{4}$ "
- 1 STAINLESS STEEL SHEET: $3\frac{15}{16}$ " x $45\frac{7}{8}$ "
- 2 STAINLESS STEEL SHEETS: $3\frac{15}{16}$ " x $17\frac{5}{16}$ "
- 2 STAINLESS STEEL SHEETS: $3\frac{15}{16}$ " X $3\frac{11}{16}$ "
- 2 STAINLESS STEEL SHEETS: $3\frac{15}{16}$ " X $6\frac{5}{16}$ "
- 1 STAINLESS STEEL SHEETS: $3\frac{15}{16}$ " X $38\frac{11}{32}$ "
- 1 STAINLESS STEEL SHEET: $23\frac{5}{8}$ " X $45\frac{7}{8}$ "

Dealer Signoff: